

**FAMILY AND CONSUMER SCIENCES EQUIPMENT**

**DOCUMENT NUMBER: 11530**

**APPLICATION: MIDDLE AND HIGH SCHOOL**

**DATE OF ISSUE:**

- 11-01-05** - **Added suggested Middle School Lab layouts**
- 07-23-04 - Revised model numbers and options
- 08-21-00 - added quiet wash option to washing machine description
- 05-06-98 - revised model numbers
- 10-01-97 - revised model numbers
- 12-15-95 - added notes below, deleted cut sheets

**NOTES:**

Refer to the ed spec to determine which equipment is required for each type of lab.  
These following products are to be specified with "no substitutions" allowed:

**ELECTRIC RANGE**

Frigidaire model FEF 364	Glass top Easy clean feature Latch free door lock Oven View window Clock and timer Color: white
--------------------------	--

**REFRIGERATOR/FREEZER WITH ICE MAKER**

Frigidaire model FRT 2195A	Pull-out glass shelves with spill guard Minimum 20 cubic foot capacity Top freezer/bottom refrigerator configuration Self defrosting Energy Efficient Color: white
----------------------------	---

**REFRIGERATOR/FREEZER WITHOUT ICE MAKER**

Frigidaire (any model)	Pull-out glass shelves with spill guard Minimum 20 cubic foot capacity Top freezer/bottom refrigerator configuration Self defrosting Energy Efficient Color: white
------------------------	---

**DISHWASHER**

Frigidaire model GLD2150R	High Temperature option Energy Star Delayed start 11-cycle Color: white
---------------------------	---

**WASHING MACHINE AND DRYER**

Frigidaire Washer GLW 1339	Top loading washer Minimum 3 cubic feet Minimum 8 wash cycles Minimum 2 speed Minimum 3 water levels Minimum 3 rinse cycles Color: white Quiet Wash Super Capacity
Frigidaire Dryer GLER 331	Minimum 5 cycle dryer Minimum 5.8 cubic feet 4 temperature settings Color: white
Frigidaire Stacked Washer and Dryer (any model)	Minimum 2 speed Minimum 6 cycle Enamel tubs Dryer: minimum 3 temperature selection Color: white

**MICROWAVE OVEN**

Amana Over-Range Microwave model ACO1860AW	Minimum 950 watts Minimum 1.5 cubic feet 10 power levels Color: white
--	--

**GARBAGE DISPOSAL**

Kitchen Aide model KCKB250G	½ horsepower
-----------------------------	--------------

**ATTACHMENTS:**

Suggested layout for Middle School Career Laboratory, dated 11-01-05  
Suggested layout for Middle School Multi-Purpose Laboratory, dated 11-01-05

**MIDDLE SCHOOL  
MULTI-PURPOSE LABORATORY  
SUGGESTED EQUIPMENT LAYOUT**  
11-01-05

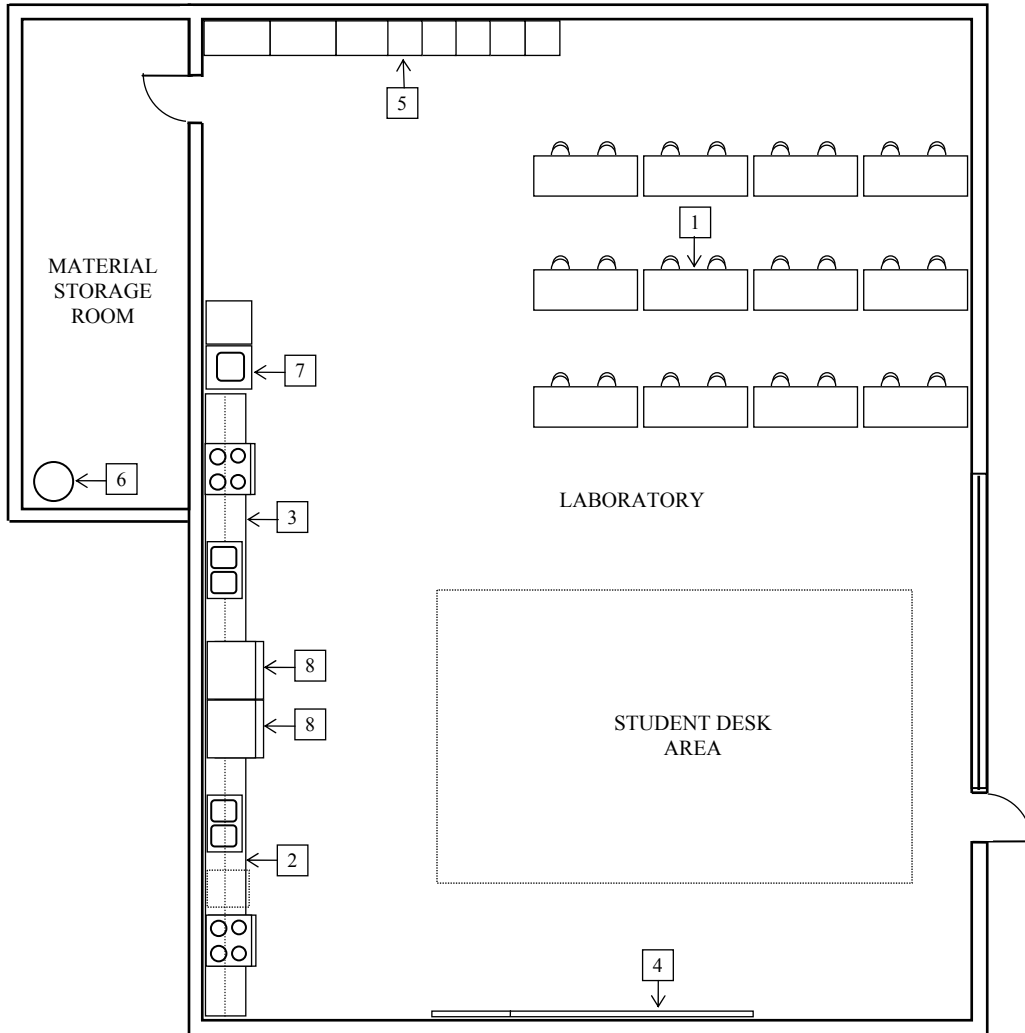

#	*	DESCRIPTION
1	C	STUDENT WORKTABLES (COMPUTERS OR SEWING MACHINES, ETC.)
2	A	DEMONSTRATION KITCHEN
3	A	STUDENT KITCHEN
4	A	TEACHING WALL
5	A	STORAGE CABINETS AS REQUIRED BY ED SPEC
6	A	WATER HEATER
7	C	WASHER/DRYER
8	C	REFRIGERATOR/FREEZER

\* = STATUS  
A - CONTRACTOR PROVIDED / INSTALLED  
B - OWNER PROVIDED / CONTRACTOR INSTALLED  
C - OWNER PROVIDED / INSTALLED

**MIDDLE SCHOOL  
CAREER LABORATORY  
SUGGESTED EQUIPMENT LAYOUT**  
11-01-05

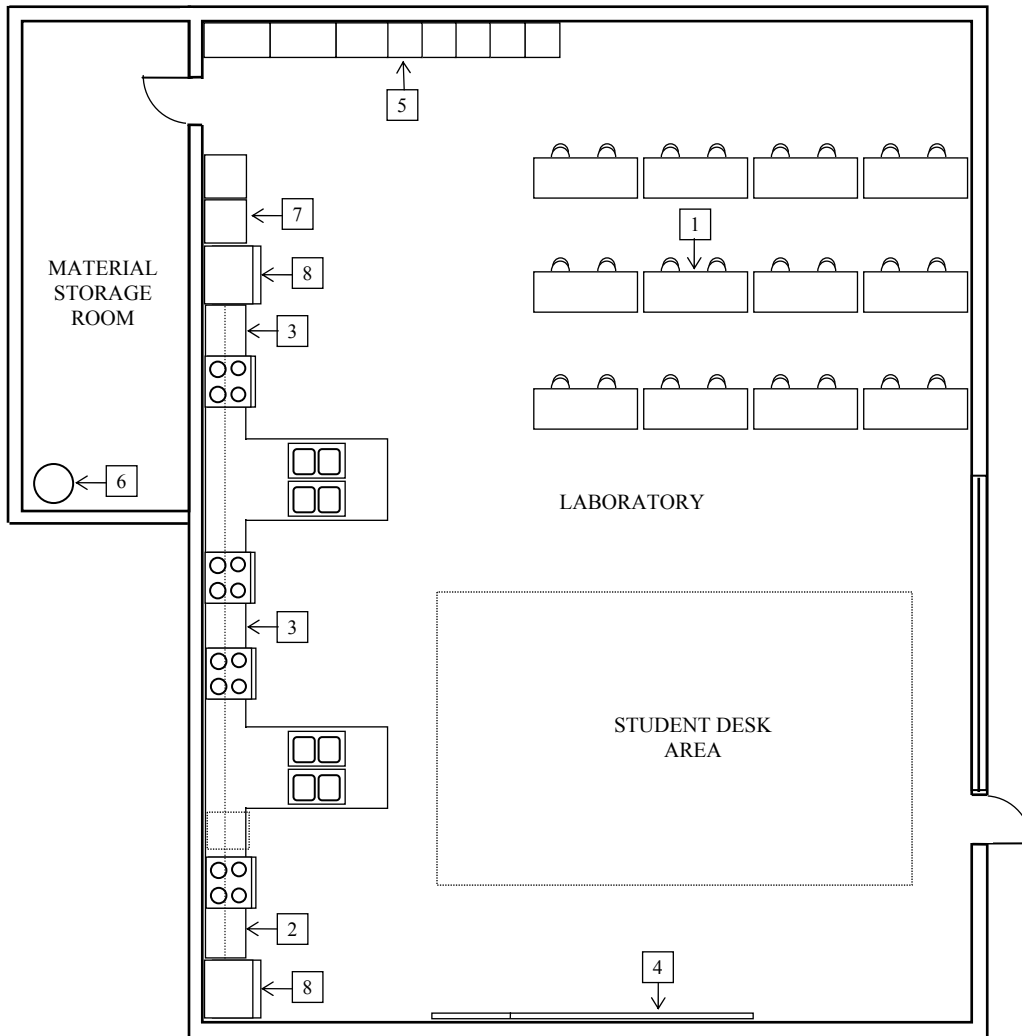

#	*	DESCRIPTION
1	C	STUDENT WORKTABLES (COMPUTERS OR SEWING MACHINES, ETC.)
2	A	DEMONSTRATION KITCHEN
3	A	STUDENT KITCHEN
4	A	TEACHING WALL
5	A	STORAGE CABINETS AS REQUIRED BY ED SPEC
6	A	WATER HEATER
7	C	WASHER/DRYER
8	C	REFRIGERATOR/FREEZER

\* = STATUS

A - CONTRACTOR PROVIDED / INSTALLED

B - OWNER PROVIDED / CONTRACTOR INSTALLED

C - OWNER PROVIDED / INSTALLED